



CLEMENTS  
HABBA



For Sale



Beaumont Road, London

£1,425,000

Freehold







## Summary Description

A stunning end of terrace Period Family Home, modernised, extended and configured as a generous three bedroom two bathroom with a separate one double bedroom apartment annex, independently accessible, at the rear of the beautiful 50 foot private garden. Located on quiet desirable residential road in Chiswick. EPC C. Offered Chain Free.

- End of Terrace Period Home
- 1985 Sq Ft ( including Annex )
- 50 Foot Landscaped Garden
- Air Conditioning, Water Softener
- EPC C
- Four Double Bedrooms, Three Bathrooms
- Excellent Condition Throughout
- Large Separate Self Contained Annex at Rear,
- Desirable Residential Road in Chiswick
- Chain Free

# Beaumont Road

Approximate Gross Internal Area = 141.6 sq m / 1524 sq ft

Eaves / Reduced Headroom = 9.7 sq m / 104 sq ft

Outbuilding = 33.2 sq m / 357 sq ft

Total = 184.5 sq m / 1985 sq ft

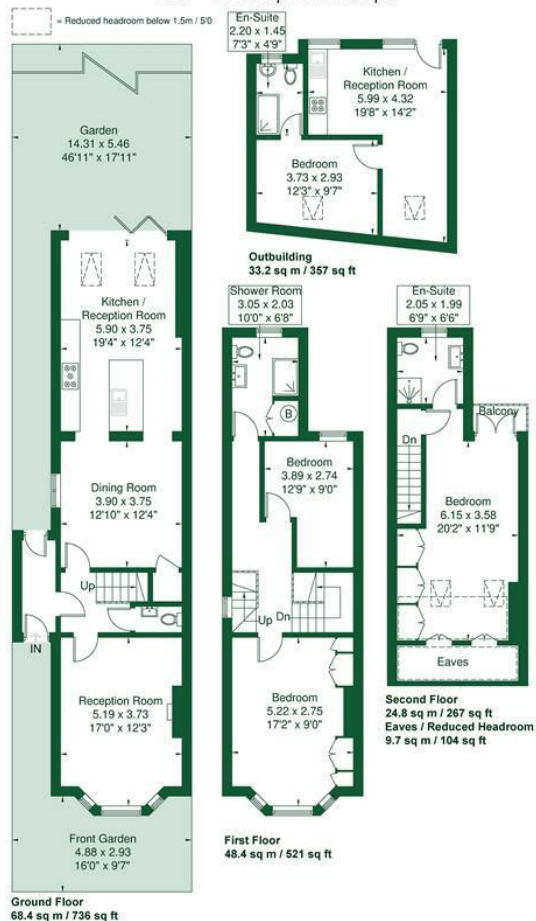

Although every attempt has been made to ensure accuracy, all measurements are approximate.

The floorplan is for illustrative purposes only and not to scale.

© www.perspective.co.uk

